

TASKalfa 7003i/8003i/9003i
TASKalfa 7353ci/8353ci

Color/Monochrome Multifunction Product
for A4/A3 Format



Enforce Multifunctional Power and Mobility Office



www.kyoceradocumentsolutions.asia

Born to be Extraordinary

KYOCERA Document Solutions is Extraordinary for

- Broad Range of Multifunction Devices and Printers
- Optimized Total Cost of Ownership (TCO)
- Reliable with Long Life Drum and Parts
- New and Advanced Technology

KYOCERA Document Solutions strives to be a company that contributes to the society and demonstrates a "Customer First" principle by providing customers with maximum value to increase their satisfaction. By adhering to the mission of producing document management devices that take balance between "Economy" and "Ecology", KYOCERA Document Solutions succeeds to develop document management devices with advanced technologies which help customers to optimize office productivity and efficiency at a low total cost of ownership and, at the same time, improving environmental performance.



Advanced Functionality

Designed with wide screen touch panel and simple operation, these multi-faceted devices offer impressive speed, large output capacity and bring high quality color print for business. They are ideal for handling day-to-day document and streaming workflow with sophisticated KYOCERA business applications.

Superior Technology

MT-730(B) for DF-7130/ DF-7110 (Optional)
7 bins Mailbox Sorter

- Allow automatic stapling, manual stapling* and booklet finishing*(Optional).
- Provide a variety of Folding Method (Center Fold or Tri-Fold**).
- Tri-Fold: 1 sheet (max. 256g/m²) to 5 sheets (max. 90g/m²).

Standard Document Processor
One-path duplex scanning and copying for max. 270 sheets

User-friendly 10.1 inch Color Touch Panel
Easy-to-view: adjustable angles

Standard Job Separator Right Tray
For max. 70 sheets

Multi-Purpose Tray
For max. 150 sheets

DF-7130 Finisher (Optional)
For max. 4,000 sheets with up to 100 sheets Staple

DF-7110 Finisher (Optional)
For max. 4,000 sheets

BF-9100 Booklet Folder for DF-7130 (Optional)
For booklet

BF-730 Booklet Folder for DF-7110 (Optional)
For booklet

PF-7130 Paper Feeder (Optional)
500 sheets Multimedia Tray and Paper Pass Unit

PF-740 Paper Feeder (Optional)
For max. 1,500 sheets (A4/Letter) x 2

PF-7120 Paper Feeder (Optional)
3,000 sheets side deck (A4/Letter)

PF-730(B) Paper Feeder (Optional)
For max. 500 sheets x2

*Optional DF-7110 or DF-7130 is required

**Optional DF-7110 & BF-730 or DF-7130 & BF-9100 are required

Superior Performance in COPY/PRINT/SCAN/FAX



Test Copy: Reduce miscopy when copying large volume by using the Test Copy mode.

Duplex Preview: Display both front and back sides before printing (Copy/Box Print function).

Skip Blank Page: Blank page is skipped during making scans/copies to save unnecessary cost.

Dedicated Preset Copy/Send Mode for Special Original Media: Newspaper Copy, Technical Drawing Copy, ID Copy, Highlightercopy and send Copy (reproduce fluorescent colors clearly) .able to select "2 levels" for highlighter.



Erase Colors: Able to select up to 6 colors and adjust "5 levels" at copy and send mode.

Ex. When you want to copy and share the meeting materials to your team leader with not neat notes writing by blue/black/red pen, you can try to use this mode.

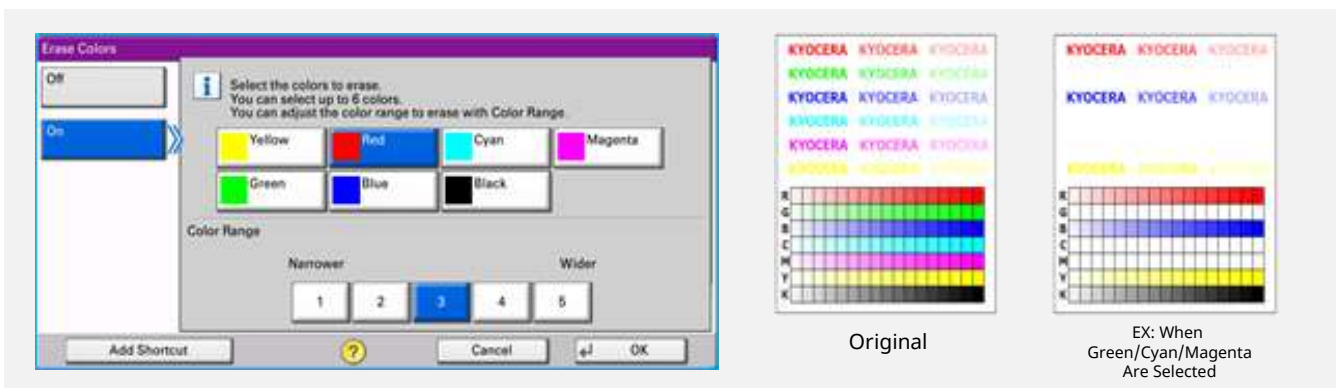

Prevent Bleed-thru: Remove unwanted background when copying or scanning printed double-sized thin paper (e.g. newspaper, NCR paper, and magazine).

Carbon Copy: Print an additional copy or copies of a document from a different media source or using a different media type.

Banner Send & Print: Scan and produce banner with various paper weight in-house anytime in need (One-sided only).

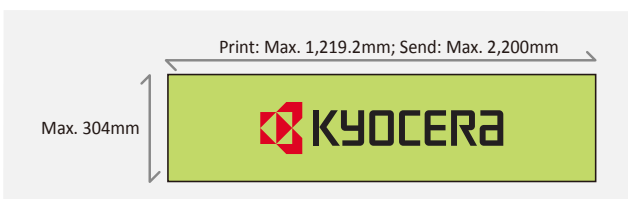

Cluster Printing: Enhance productivity by executing one print job via 2 to 4 designated KYOCERA devices with optional KYOCERA Business Application.

Customize Scan Split: Scan by split at specified page and allow send all scan files via one email or send files separately by emails.

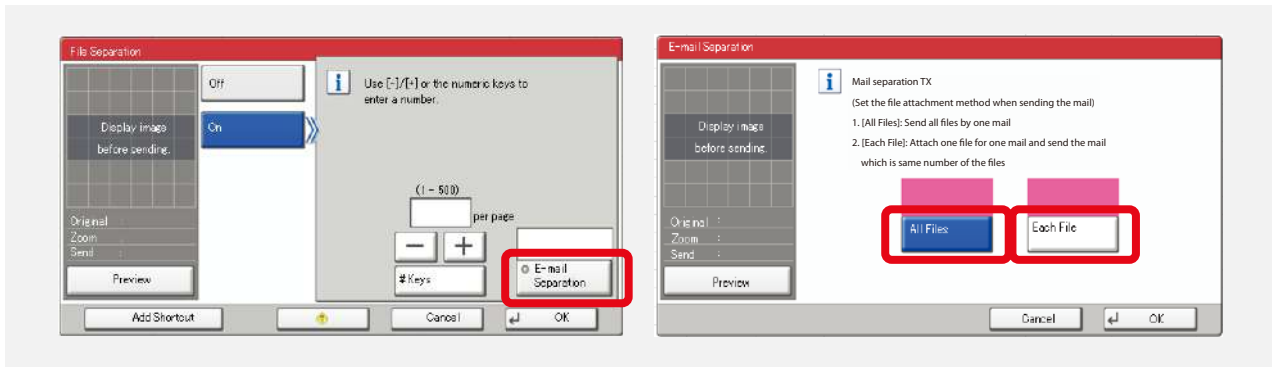

USB Scan to/Direct Print: Scan to or print directly from USB Memory in PDF, PDF/A, TIFF, JPEG or XPS format.

Scanned Image File Size Check: Check the actual scanned document size does not exceed limit before actual sending to e-mail.

FTP/SMB/Email/Fax Multi-Sending: Send document to different destinations (email addresses, folders, etc.) in a single scan operation.

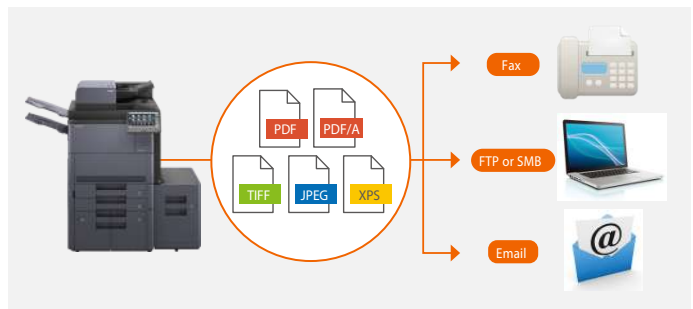

Simple Fax Forwarding: Forward any incoming fax to other destinations by Email, SMB or FTP (Optional)



i-FAX Sending (Optional): Send and receive i-FAX without the mail service by installing Direct SMTP function.

Job Skip: Automatically prioritize the error print job to avoid machine come to a halt in case of

1. Paper empty in specific tray
2. Mismatched paper size
3. Mismatched media type



Job Finish Notice: Send email notification to specified user when a copy/scan job is completed.



Maximize Efficiency

Intuitive 10.1 Inch Color Touch Panel with Easy Navigation

Excellent clarity 10.1 inch color touch panel display with swivel type operability similar to smart phone. Easy to notice FAX reception because green LED is for Job Separator only.

Convenience to use Keypad

With on-screen virtual numeric keypad and optional hardware keypad, users can type in with ease.



Customizable Home Screen

All commonly used functions and applications are set as default on Home Screen. The Home Screen can be customized easily to meet different use (or Group User) needs for immediate access to commonly used functions.

Printer Driver's Quick Print Tab

Create and save frequently used custom profiles as graphic icons to allow programming of complex jobs in one click.

Custom Box

Ease-of-use Custom Box provides long term job storage at device, allowing users to securely print and store jobs on the device and output them when required.

Superior Quality

Powerful color performance*

- o Vibrant color* with 1,200 x 1,200 dpi print resolution
- o Multiple Image Adjustment Tools for output that matches your needs:

Color Optimizer at KYOCERA KX Driver*

Allow users to adjust the pixels near the color value or color space of defined areas instead of the entire image by selecting 2 from 3 parameters (Hue, Light, Saturation) and add up to 10 colors in each adjustment settings.

One-Touch Color Image Adjustment*

Total 9 photo adjustment modes to select optimal settings for photo image (Portrait; Blue Scenery; Green Scenery; Vivid; Soft; Sharp; Smooth; Light; Heavy).

Print Gray with Black Toner*

Improve text recognition and decreases color shadowing to reproduce accurate grayscale image.

*TASKalfa 7353ci/8353ci only



Transform Business with KYOCERA Solutions

KYOCERA Capture Manager

A powerful document capturing software product that streamlines business workflow by digitizing documents. It enables to capture the documents from virtually any source - from an MFP, network scanner, Web browser, Email, hot-folder and smartphone. Once documents are captured, and it goes through image processing, and those processed documents can be converted into a variety of formats, such as text searchable PDFs or Office format, and finally distribute to different business systems (Email, Folder, Cloud, DMS/ECM, ERP).

KYOCERA Mobile Print

An app-based solution that enables users to simply and conveniently print documents, web pages, and images on demand from virtually anywhere, on their Apple and Android smartphone and tablet devices to select KYOCERA MFPs and printers. Users can also scan files and images from same MFPs to their mobile devices. Our devices also support AirPrint for iPhone and iPad.

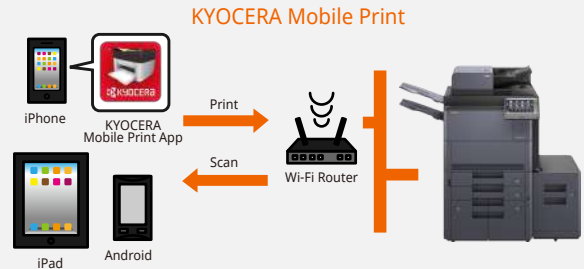

KYOCERA MyPanel

Use smartphone or tablet to connect a compatible networked KYOCERA printing device on your local Wi-Fi network wirelessly. Users can perform COPY/PRINT/SCAN from Custom Box or Cloud** by mobile devices with personalize settings.

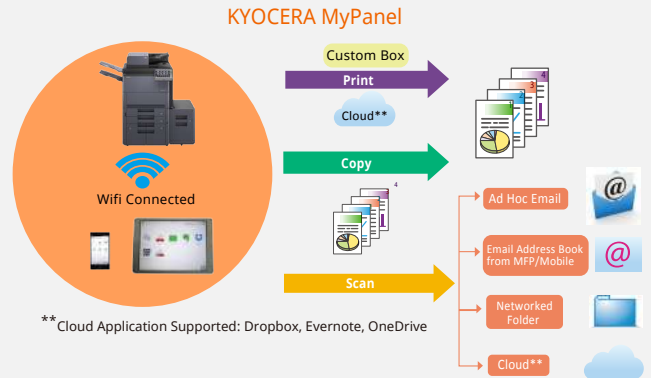

KYOCERA Cloud Connect (Optional)

Retrieve and print files in Google Drive and Evernote®, a cloud service provider, directly from any KYOCERA HyPAS-enabled MFPs. Users can even upload scanned files directly to Google Drive and Evernote® - directly from the MFP, without going through a computer.

Support WiFi Direct

Support IB-35 Wireless LAN (Optional), makes print/scan via AirPrint/Google Cloud Print/Mopria/KYOCERA Mobile Print/ KYOCERA MyPanel much easier.

NFC (Near Field Communication)

Built in at Control Panel to connect with Android devices.

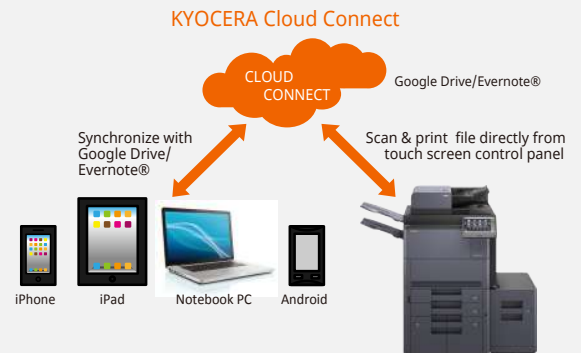



Control with Ease

Password Protection Setting: Allow administrator to set Password Policy to limit user access to designated capacity.

Private Print: Release print job at the device by entering a preset four-digit access code when making a print at KYOCERA KX Driver.

With the aid of **Network Authentication**, IT Department can manage user authentication easily by incorporating with centralized Authentication Server (NTLM, Kerberos, KYOCERA Net Manager*).

Security Watermark: Distinguish original from copies and provides protection for sensitive document against duplication.

KYOCERA Data Security Kit: Encrypt data before storing in the hard drive and automatically overwrite all data stored in the hard drive when the data becomes unnecessary.



TPM (Trusted Platform Module): TPM is a hardware chip that encrypts and decrypts data. Data stored in a dedicated storage area mounted on the TPM chip can never be accessed from an external device, so confidential information can be safely stored.

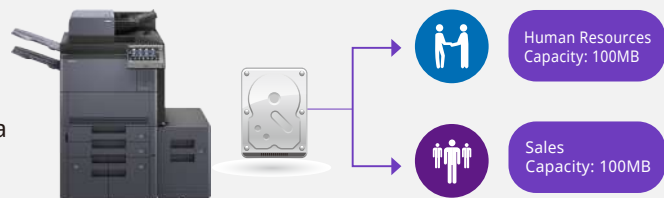

FAX Memory Overwrite (Optional): Erase FAX memory after sending or receiving for confidentiality.

Card Authentication Kit (Optional): Prevent unauthorized data access to device, manage and control usage with IC Card Authentication.

M-Files (Optional): Manage all information e.g. documents, projects and business processes etc and adds intelligence by combining it with information from other systems (like SharePoint, Salesforces and SAP). This ensures you always find what you need, no matter what system you are using.

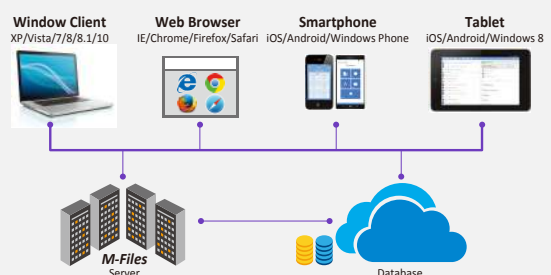



Eco-Conscious

Design for energy savings

Fast warm up: With the new IH fuser, the warm up time is shorter and power consumption is less.

Weekly Timer: Allow administrator to preset the machine on and off time to maximize power savings.

EcoPrint: Flexible EcoPrint setting to consume less energy and toner.

Energy Saver: 0.7W or less power consumption at Energy Saver Mode.

Protect the environment

- Leading Long-life KYOCERA proprietary Amorphous Silicon (a-Si) Drum, developer and replacement parts.
- Parts for Recycling.
- Non-toxic Materials.
- Quiet operation design for a comfortable Working Environment.

Eco Mark (Japan) EcoLeaf Environmental Label (Japan) Law on Promoting Green Purchasing (Japan)

KYOCERA Document Solutions has been actively promoting the acquisition of various environment labels, aiming to provide products that are safe and comfortable for our customers to use and have minimal environmental impact.

Instant Monitoring

Smart utilities for managed print and minimize related device management costs.

KYOCERA Command Center RX:

By using a web browser, the authorized administrator can access the built-in KYOCERA Command Center RX and check the operation status of the device, toner level, paper availability, as well as change settings related to security, network printing and advanced network setting etc.



KYOCERA Net Viewer:

A comprehensive network management tool used to monitor, maintain, and update up to 100 network printing devices locally and remotely. Through KYOCERA Net Viewer, administrators can simply install and update firmware on all KYOCERA connected devices while easily monitoring printed black/color pages, device configuration, accounting, toner usage, and alerts. By implementing KYOCERA Net Viewer, the manpower required to monitor connected devices is greatly reduced.



KYOCERA Net Manager (Optional):

Protect confidential data, manage & control the overall output (copy/print/scan) and get detailed reports. Users can keep an overview of personal printing jobs with web browser. It greatly simplifies scanning processes as it automatically displays a set of personalized options.

By adding the Card Authentication Kit (Optional) for KYOCERA Net Manager, you are able to swipe ID Card to get print document directly. User administrator can also set the IC Cards to allow quick and secure access with pre-defined user restrictions such as color output restrictions and output quota.

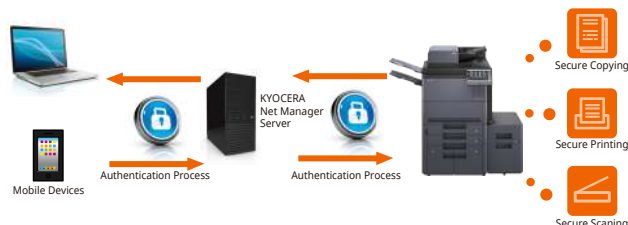

Main Specifications

Model	TASKalfa 7003i	TASKalfa 8003i	TASKalfa 9003i	TASKalfa 7353ci	TASKalfa 8353ci	
Main Function	Copy, Print, Scan, Fax (Optional)					
Writing Method	Semiconductor Laser					
CPU	QoriQ T1024 (Dual Core) 1.4GHz			QoriQ T1024 (Dual Core) 1.2GHz		
Print Speed (A4) (Mono/Color)	70/ - ppm	80/ - ppm	90/ - ppm	73/65 ppm	83/70 ppm	
Scanning Speed (A4) 300dpi (Mono/Color)	Simplex 120/120 ipm		Duplex 220/220 ipm			
Memory	Standard 4.5GB (Max. 4.5GB)					
SSD/HDD Capacity	SSD 8GB (Standard) / HDD 320GB (Standard)					
Warm Up Time	30 seconds or less			44 seconds or less		
Paper Capacity	Standard	4,150 sheets [2 x 500 sheets (Cassette) + 2 x 1,500 sheets (Cassette) + 150 sheets (MPT)]				
	Maximum	7,650 sheets (Main Unit + 2 x 1,500 sheets PF-740(B) x1 + 500 sheets PF-7130 x 1 +MPT)				
Paper Size	Cassette	Max. 12" x 18" (304mm x 457mm) - Min. A5R				
	MPT	Max. 12" x 18" (304mm x 457mm) & Banner Print of 1,219.2mm - Min. A6R				
Paper Weight	Cassette	60 to 256 g/m ²				
	MPT	60 to 300 g/m ²				
Document Processor	Standard / Dual Scan / 270 Sheets					
Duplex Printing	Paper size: 12" x 18" (304mm x 457mm) - A5R; Paper weight: 60 - 256 g/m ²					
Output Capacity	Max. 420 sheets					
Control Panel	10.1 inch Color Touch LCD Panel					
Dimension (W x D x H) (Main Unit)	750mm x 822mm x 1,234mm (with DP)					
Weight (Main Unit)	Approx. 150 kg			Approx. 182 kg		
Power Consumption (Standard configuration)	Copy/Print Mode	1,110W	1,170W	1,340W	1,330W	
	Stand-by Mode	100W			120W	
	Energy Saver	0.7W				
Noise (ISO7779/ ISO9296)	Copy/Print Mode	75dB(A)				
	Stand-by Mode	58dB(A)				
Copy Functions (Standard)						
Copy Size	Max. A3 (Legal) - Min. A6R					
Resolution	600 x 600 dpi					
First Copy Time (Mono/Color)	4.2/ - seconds	3.7/ - seconds	3.6/ - seconds	5.4/6.2 seconds	4.8/5.9 seconds	
Zoom Ratio	25% to 400% (1% per Step)					
Multiple Copy	1 to 9999					
Print Functions (Standard)						
Resolution	1200 x 1200 dpi, 4,800 Equivalent x 1200 dpi					
PDL	PRESCRIBE, PCL6 (PCL-XL, PCL5e), KPDL3 (Postscript 3 compatible), XPS, Open XPS, PDF Direct Print, PPML			PRESCRIBE, PCL6 (PCL-XL, PCL5c), KPDL3 (Postscript 3 compatible), XPS, Open XPS, PDF Direct Print, PPML		
First Print Out Time (Mono/Color)	4.8/ - seconds	4.1/ - seconds	4.0/ - seconds	5.3/6.3 - seconds	4.9/6.1 - seconds	
Network Printing	TCP/IP, NetBEUI, IPv4, IPv6, IPsec, HTTP, LPD, FTP, IPP, RawPort, LLTD, SNMP, DHCP, SMTP, POP3, DNS, SNMPv1/v2, WSD Scan/Print					
Operating System Supported Interface	Windows: 7/8.1/10, Server:2008/2008 R2/2012/2012 R2/2016; Apple Macintosh: OS X 10.9 or later; Linux					
USB Memory Printing	USB 2.0 High Speedx1; Ethernet 10BASE-T/100BASE-TX/1000BASE-T; USB Host Interface (USB Host)x4; NFC TAGx1; Expansion Slotx2; 802.11 b/g/n/Wireless LAN/WiFi Direct (Optional)					
Mobile Printing	Supported					
	AirPrint, Mopria, KYOCERA Mobile Print, NFC					
Scan Functions (Standard)						
Color Selection	Auto Color (Color/Gray); Auto Color (Color/B&W); Full Color; Grayscale; Black & White					
Resolution	600dpi, 400dpi, 300dpi, 200dpi, 200x100dpi, 200x400dpi					
File Format	TIFF, JPEG, XPS, Open XPS, PDF (MMR/JPG compression/High-compression PDF), Searchable PDF, MS Office File					
Image Type Mode	Text, Photo, Text + Photo, Text (Fine Line), OCR					
Transmission Type	Scan to SMB; Scan to E-mail ; Scan to FTP or FTP over SSL; Scan to USB; TWAIN Scan; WSD Scan					
Address Storage	2000 addresses (Common address list), 500 groups (Group address list)					
Fax Functions						
Original Size	Max. A3 (Ledger) - Min. A6 (Statement) / Scanning length: max. 1,600mm					
Coding Method	MMR, MR, MH, JBIG					
Transmission Speed / Modem Speed	Less than 3 seconds / 33.6 Kbps					
Memory	170MB					
Fax Functions	Network Fax, Duplex Transmission and Reception, Encrypted Transmission and Reception, Polling Transmission and Reception, Broadcast, Fax Server Integration, Fax Dedicated Paper Feed tray					
Consumables & Options						
Toner Kit	TK-6720: 70,000 pages			TK-8730 K : 85,000 pages; TK-8730 C/M/Y : 40,000 pages		
Maintenance Kit	MK-6725 : 600,000 pages			MK-8720 A : 600,000 pages; MK-8720 B : 600,000 pages		
Paper Feeder	PF-730(B): 500 sheets x2; PF-740(B): 1,500 sheets x2 (A4/Letter); PF-7120: 3,000 sheets Large capacity side deck (A4/Letter); PF-7130: 500 sheets Multimedia Tray and Paper Pass Unit					
Finisher	DF-7110: 4,000 sheets Finisher with 50 sheets Staple; DF-7130: 4,000 sheets Finisher with 100 sheets Staple; PH-7C: Punch Unit; MT-730(B): 7 Bin Mailbox; BF-730: Booklet Folder for DF-7110; BF-9100: Booklet Folder for DF-7130; SH-10: Staple for BF-730/BF-9100; SH-12: Staple for DF-7110; SH-14: Staple for DF-7130					
FAX System	FAX System 12					
Internet FAX	Internet FAX Kit (A)					
Embedded OCR	Scan Extension Kit(A)					
Card Authentication	Card Authentication Kit(B)					
Gigabit Ethernet Board	IB-50: For Additional Network					
Wireless LAN Interface	IB-35 (802.11 b/g/n/Wireless LAN/WiFi Direct)					
Banner Paper Tray	Banner Guide (A)					
Numeric Key Pad	NK-7120					
Copy Tray	Copy Tray (D)					
Original Hard Copy Holder	DT-730 (B)					

KYOCERA Document Solutions Asia Limited

13/F, Mita Centre, 552-566 Castle Peak Road,
Tsuen Wan, N.T., Hong Kong
Tel : +852-2496-5678 Fax: +852-2610-2063



www.kyoceradocumentsolutions.asia

Kyocera Document Solutions does not warrant that any specifications mentioned will be error-free. Specifications are subject to change without notice. Information is correct at time of going to press. All other brand and product names may be registered trademarks or trademarks of their respective holders and are hereby acknowledged.